

# Pressure Transmitter



PC-300 series is high accuracy pressure sensor with superior temperature characteristic. SUS316L is used for gas (fluid) contacting area for superior corrosion resistance. Selectable output either 4 to 20mA, 0 to 5V or 0 to 10V enables easy connection with various digital panel meters and programmable controllers.

### High Accuracy / High Reliability

- High accuracy and reliability with 0.25% maximum deviation from best fit line affected by linearity, hysteresis repeatability.

### Wide Measurement Range

- Wide pressure range available; Gauge pressure 0 to 172.4KPa (1.76kgf/cm<sup>2</sup>) to 20,684KPa (210kgf/cm<sup>2</sup>), absolute pressure from 0 to 2,586 torr. Vacuum draw available as option.

### Long Lifetime

- Cycle duration test, 1,000,000 times or more, conducted in each range.

### I/O

- Selectable 4 to 20mA, 0 or 5V or 0 to 10V

### Specification

Model	PSI	Gauge Pressure ※						Absolute Pressure		
		25G	50G	100G	200G	500G	3000G	15A	25A	50A
Pressure Range	KPa	0 to 172.4	0 to 344.7	0 to 689.5	0 to 1,378.9	0 to 3,447.3	0 to 20,684	0 to 103.4	0 to 172.4	0 to 344.7
	kgf/cm <sup>2</sup>	0 to 1.76	0 to 3.52	0 to 7.03	0 to 14.06	0 to 35.16	0 to 210.9	-	-	-
	torr	-	-	-	-	-	-	0 to 776	0 to 1,293	0 to 2,586
Accuracy (% Full Scale)		±0.5%		±0.25%				±0.5%		

※For gauge pressure type, output reference can be set to vacuum (-100KPa) as option. Specify when you order.

Overload Pressure	Full Scale ×2
Storage Temperature	-40 to 85°C (no power distribution)
Guaranteed Temperature	0 to 70°C
Temperature Drift	±0.05% FS/°C
External Leakage	2×10 <sup>-11</sup> Pa·m <sup>3</sup> /sec
Gas (Fluid) Contacting Area	SUS316L
Joint	1/4" VCR®, Swagelok®, UJR®, and others

Model	304	305	310
Excitation (Power Supply) Voltage	DC 12 to 26V	DC 12 to 26V	DC 12 to 26V
Signal Output	4 to 20mA	0 to 5V	0 to 10V
Span	16mA ± 0.16mA	5V ± 0.5V	10V ± 1V
Offset	4mA ± 0.4mA	0V ± 0.1V	0V ± 0.1V

### Dimensional Outline Drawings

PC-304A-VR-[Pressure Range]-M PC-304T-VR-[Pressure Range]-M PC-305A-VR-[Pressure Range]-M PC-305T-VR-[Pressure Range]-M

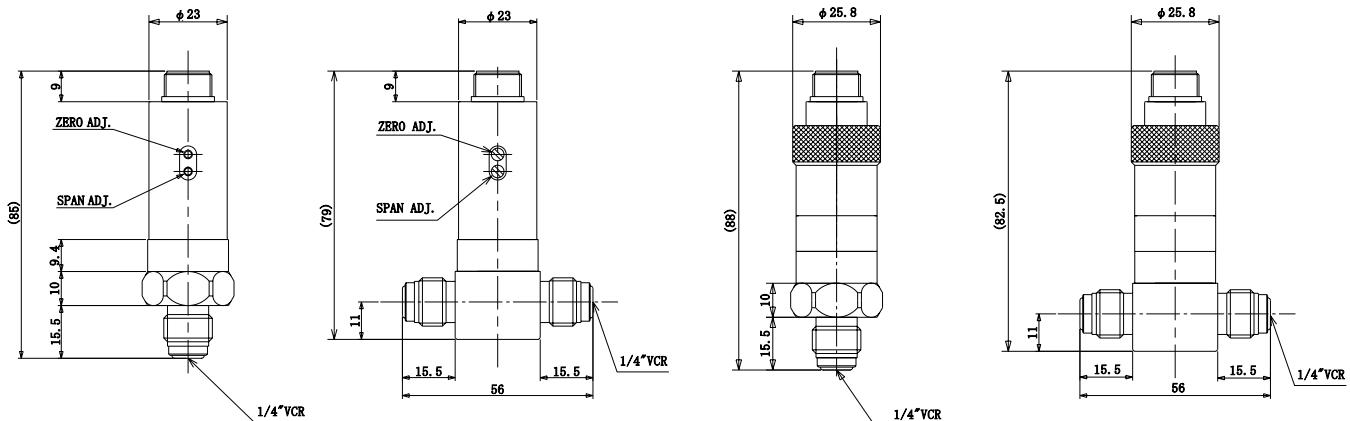

### How to Order

**PC - 304 A - VR - 100G - M - CT - V**

<b>Signal Output</b> 304 : 4 to 20mA 305 : 0 to 5V 310 : 0 to 10V	<b>Piping Connection</b> A : Straight T : T Angle	<b>Shape of Joint</b> VR : 1/4"VCR® SW : 1/4"Swagelok®	<b>Pressure Range</b> 25G : 0 to 172.4KPa 50G : 0 to 344.7KPa 100G : 0 to 689.5KPa 200G : 0 to 1,378.9KPa 500G : 0 to 3,447.3KPa 3000G : 0 to 20,684KPa 15A : 0 to 103.4KPa 25A : 0 to 172.4KPa 50A : 0 to 344.7KPa	<b>Figuration of Screw</b> M : Male Screw (Standard) F : Female Screw Blank : Atmosphere Pressure V : Vacuum ※Gauge pressure type only.	<b>Output Standard</b> CT : Current Output V : Voltage Output
--	---	--	--	--	---

●Connection cable separately available (see P. 84)

※Specification is subject to change without notice.

Pressure  
Sensor